

USE & CARE INSTRUCTIONS



InvisiClean Sensa Air Purifier (Model IC-5120)

If you have any questions, please email us at Support@InvisiClean.com or call us at 818-787-1188 Monday – Friday 9AM-5PM Pacific time for immediate assistance.

READ AND SAVE THESE INSTRUCTIONS WARNINGS

**Failure to comply with the warnings listed below may
result in electric shock or serious injury.**



This product should be used only in accordance with the specifications outlined in this manual. Usage other than what has been specified here may result in serious injury.

When using electrical appliances, basic precautions should always be followed to reduce the risk of fire, electric shock and injury to persons, including the following:

- Read all instructions before using appliance.
- **IMPORTANT** - This appliance has a polarized plug (one blade is wider than the other). To reduce the risk of electric shock, this plug is intended to fit in a polarized outlet only one way. If the plug does not fit fully in the outlet, reverse the plug. If it still does not fit, contact a qualified electrician. Do not attempt to defeat this safety feature.
- To avoid fire or shock hazard, plug the appliance directly into a right AC electrical outlet.
- Keep the cord out of heavy traffic areas. To avoid fire hazard, NEVER put the cord under rugs, near heat registers, radiator, stoves or heaters.
- To protect against electrical hazards, DO NOT immerse in water or other liquids. Do not use near water.
- Children cannot recognize the hazards associated with the usage of electrical appliances. For this reason, always supervise children when they are near the unit.
- Always unplug the air purifier before moving it, opening the grill, changing filters, cleaning or whenever the air purifier is not in use. Be sure to pull by the plug and not the cord.
- NEVER drop or insert any object into any openings.
- DO NOT run cord under carpeting.
- DO NOT cover cord with throw rugs, runners, or similar coverings.
- DO NOT route cord under furniture or appliances. Arrange cord away from traffic area and where it will not be tripped over.
- DO NOT operate any appliance with a damaged cord or plug, if motor fan fails to

rotate, after the appliance malfunctions, or if it has been dropped or damaged in any manner. Send to Customer Service for assistance.

- Use appliance only for intended household use as described in this manual. Any other use not recommended by the manufacturer may cause fire, electric shock or injury to persons.
- DO NOT use outdoors.
- DO NOT place anything on top of unit.
- NEVER block the air openings, grills/outlets or place on a soft surface such as a bed or sofa, as this could cause the unit to tip over, blocking the air intake or outtake opening.
- DO NOT attempt to repair or adjust any electrical or mechanical functions on this unit. Doing so will void your warranty. The inside of the unit contains no user serviceable parts. All servicing should be performed by qualified personnel only.
- WARNING: To reduce the risk of fire or electric shock, do not use this device with any solid-state speed control device.

TECHNICAL SPECIFICATIONS

Rated Voltage: AC110V-240V, 60Hz

Rated Power: 55W

Noise Level: From 30dB(LOW) to 55dB(TURBO)

Dimensions: 12.34(L)x6.25(W)x17.75(H)inches

PRODUCT DIAGRAM

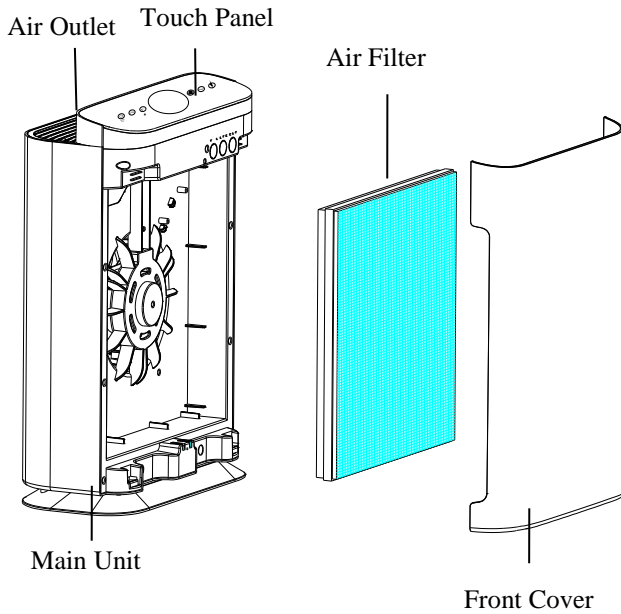

AIR CLEANING SYSTEM

PRE-FILTER: Captures initial dust and allergen particles.

ACTIVATED CHARCOAL: Absorb formaldehyde, benzene and other VOC gases.

TRUE HEPA: Captures dust, smoke, pollen and other allergens.

OPERATING INSTRUCTIONS

BEFORE OPERATING THE AIR PURIFIER:

1. Carefully remove your air purifier from box and plastic bag.

2. Select a firm, level and flat location for the air purifier.

*For proper air flow, locate the unit at least 1 foot from any wall or furniture.

*Make sure none of the grills are blocked.

3. Before using, remove the filters then remove and discard bags.

4. Plug the power cord into a right voltage AC outlet.

IMPORTANT: When moving the air purifier, always lift unit by the carrying handle located on back.

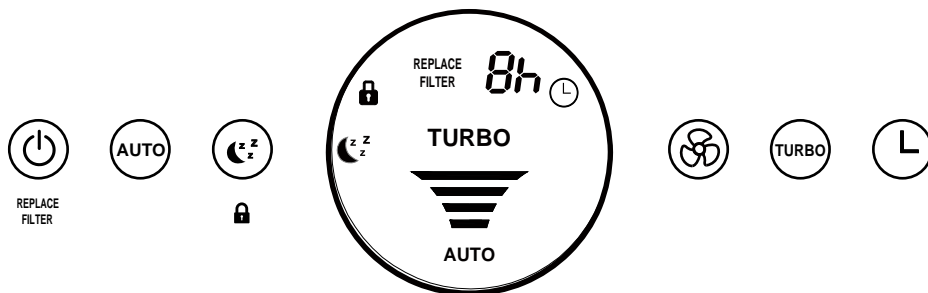

OPERATING THE AIR PURIFIER



1. “POWER” BUTTON:

Press this button to turn the unit on or off.

Note: When the “REPLACE FILTER” indicator appears, press and hold this button to reset the replace filter indicator.



2. “AUTO” BUTTON:

Press this button to turn on the AUTO mode. During AUTO mode, fan speed will automatically change according to the air quality level.

The InvisiClean Sensa features a state of the art PM2.5 sensor which will sense the

amount of pollutants in the air and automatically raise and lower the fan speed. Below is the list of air quality level and the corresponding fan speed.

Air Quality	Fan Speed	Light Color
Excellent	1	Blue
Good	2	Blue
Moderate	3	Yellow
Moderate	4	Yellow
Bad	5	Red
Very Bad	Turbo	Red



3. “**SLEEP**” BUTTON:

Press this button to turn on SLEEP mode. During sleep mode, all the LED lights on the unit will be off and the device keep will stay on. Press any button to cancel the sleep mode.

Note: Pressing this button for 3-5 seconds will activate the Child Lock function. During Child Lock mode, all the buttons presses are ignored. To turn off child lock, press this button again for 3-5 seconds.



4. “**FAN**” BUTTON:

Press this button to adjust the fan speed from Level 1 to 5.



5. “**TURBO**” BUTTON:

Press this button, the air purifier will operate in Turbo Speed. Turbo mode should be used during times of heavy pollution to clean the air as fast as possible.



6. “**TIMER**” BUTTON:

- 1) By pressing this button, the purifier can be timed to operate for intervals of 1 to 9 hours, stopping automatically when the selected operating time has elapsed.
- 2) Press this button (Timer) to select the desired operating time. The LED light automatically indicates the remaining operating time.
- 3) To select the continuous operating mode, press the button repeatedly until there are no more indicator lights.

Important note: When the unit is not in use, switch it off and unplug it.

INSTALLING & REMOVING FILTERS

FILTER REPLACE INDICATOR

The REPLACE FILTER shows up indicates that it is time to replace the filter. Replace the filter according to the directions then press the POWER button and hold for 5 seconds to restart the system. The REPLACE FILTER light will turn off.

*Filters will last approximately 6 months under normal use.

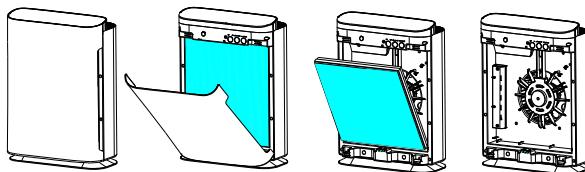

1. Open the front cover from the top.
2. Remove the filter by pulling the two tabs on the left and right.
3. Insert a new filter into the unit. Consult the sides of the filter for correct installation direction.
4. Reattach the front cover of the unit and securely latch into place.
5. Press and hold POWER button for 5 seconds to reset Filter Change Indicator.

CLEANING & MAINTAINING THE COMBINATION FILTER

The air purifier should be cleaned at least once every month and the outer Pre-/Activated Carbon Filter attached to the HEPA Filter should be cleaned every month. More frequent cleaning may be required depending on environmental conditions.

FILTERS

Clean with the brush attachment of your vacuum cleaner. This will remove lint and dirt.

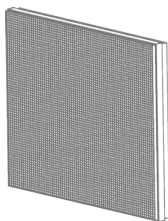

Filter

NOTE:

-The filter in your unit combines multiple layers: the Carbon coated pre-filter and HEPA Filter.

AIR QUALITY SENSOR MAINTENANCE

Air Quality Sensor

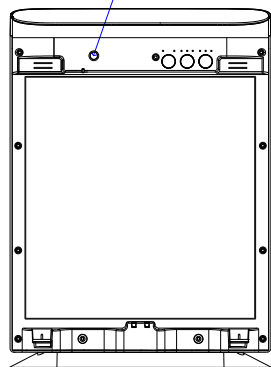

If the air quality display is incorrectly showing yellow or red, we recommend cleaning the air quality sensor port located in the diagram above. To clean the port, use compressed air to blow debris out of the port.

Troubleshooting Guide

Problem	Solution
Unit will not turn on	Make sure front cover is on properly by making sure the bottom hook latches are on properly.
Air quality sensor is constantly red	Please clean air quality sensor. Please see the “Air quality sensor maintenance” section for more details.
Airflow is weak	Check the air filter and replace it.
Power light is blinking	This is the filter reset indicator. Check the air filter and replace it. Press and hold the power button to reset it.
Sensor is not changing colors	The air sensor will change colors based on PM2.5 air quality. You can test if its working properly by lighting a candle or match nearby.

MAINTENANCE CAUTION

Use a clean, dry, soft cloth to wipe the external surface of the unit.

NOTE: Do NOT stick any foreign objects or your fingers inside of the unit.

CAUTION: Do NOT use gasoline, benzine, thinner, harsh cleaners, etc. on and/or in the unit while cleaning as they will damage the product.

NEVER use alcohol or other solvents.

Warranty: 1 year from the date of purchase.

Dear Consumer,

InvisiClean warrants this product to be free of defects in materials or workmanship commencing upon the date of the original purchase. Save your original sales receipt to validate start of warranty period. Warranty is not valid without receipt. If this product should become defective within the warranty period, we will repair or replace any defective parts free of charge. All warranty repairs must be completed by InvisiClean. This warranty does not cover unauthorized repairs. The warranty does not include unusual wear, damage resulting from accident, or unreasonable use of the product. This warranty only covers the product when used with genuine InvisiClean accessories. This warranty covers product that was purchased from authorized distributors. This warranty gives you specific legal rights and you may also have other rights (other rights may vary from state to state in the U.S.A.). To

submit product under warranty the complete machine must be delivered pre-paid to InvisiClean. Please include complete information including: the problem, the model number of the product, the day of purchase, and a copy of the original sales receipt along with your name, address, and telephone (email optional). Please contact the original authorized retailer for return authorization and instructions.



Need a reminder to change filters?
Subscribe and Save 20% on
Filters and get FREE SHIPPING



Go to: **invisiclean.com/save**
No commitments or hassles
and cancel online anytime.