



**AIR PURIFIER** with TRUE HEPA FILTER

Model No.: IC-6022-Black



## **READ AND SAVE THESE INSTRUCTIONS:**

Failure to comply with the warnings listed below may result in electric shock or serious injury



This product should be used only in accordance with the specifications outlined in this manual. Usage other than what has been specified here may result in serious injury.

**WARNING: The cords, wires and/or cables supplied with this product contain chemicals, including lead or lead compounds, known to the state of California to cause cancer and birth defects or other reproductive harm. Wash hands after using. (California Code of Regulations Proposition 65)**

When using electrical appliances, basic precautions should always be followed to reduce the risk of fire, electric shock and injury to persons, including the following:

- Read all instructions before using appliance.
- IMPORTANT - This appliance has a polarized plug (one blade is wider than the other).
- To reduce the risk of electric shock, this plug is intended to fit in a polarized outlet only one way. If the plug does not fit fully in the outlet, reverse the plug. If it still does not fit, contact a qualified electrician. Do not attempt to defeat this safety feature.
- To avoid fire or shock hazard, plug the appliance directly into a 120V AC electrical outlet.
- Keep the cord out of heavy traffic areas. To avoid fire hazard, NEVER put the cord under rugs, near heat registers, radiator, stoves or heaters.
- To protect against electrical hazards, DO NOT immerse in water or other liquids. Do not use near water.
- Children cannot recognize the hazards associated with the usage of electrical appliances. For this reason, always supervise children when they are near the unit.

- Always unplug the air purifier before moving it, opening the grill, changing filters, cleaning or whenever the air purifier is not in use. Be sure to pull by the plug and not the cord.
- NEVER drop or insert any object into any openings.
- DO NOT run cord under carpeting.
- DO NOT cover cord with throw rugs, runners, or similar coverings.
- DO NOT route cord under furniture or appliances. Arrange cord away from traffic area and where it will not be tripped over.
- DO NOT operate any appliance with a damaged cord or plug, if motor fan fails to rotate, after the appliance malfunctions, or if it has been dropped or damaged in any manner.
- Use appliance only for intended household use as described in this manual. Any other use not recommended by the manufacturer may cause fire, electric shock or injury to persons.
- DO NOT use outdoors.
- DO NOT place anything on top of unit.

	<b>LAMP CONTAINS MERCURY</b>	
<b>Manage in accordance with Spills, Disposal and Site Cleanup Requirements. In case of breakage, follow clean-up procedures provided by contacts below.</b>		
<b><a href="http://www.epa.gov/cflcleanup">www.epa.gov/cflcleanup</a> 1-866-284-4010</b>		

## MAIN PARTS

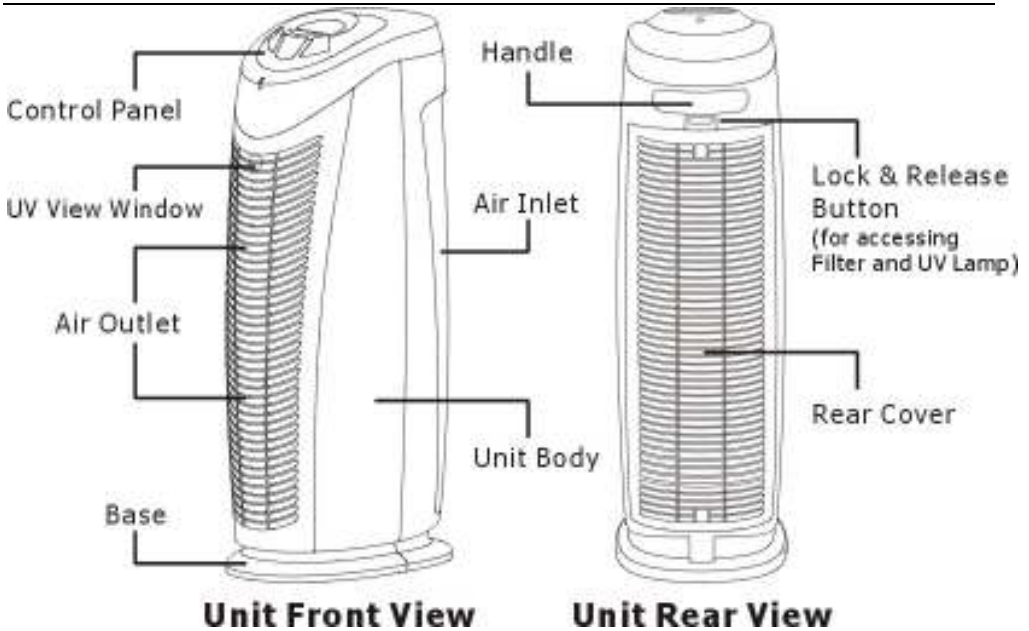

## OPERATION

### PREPARING FOR FIRST USE

1. Carefully unpack your air purifier from the box and remove from the plastic bag.
2. Select a firm, level and flat location. For proper air flow, place the unit at least 1 foot from any wall or furniture. Ensure no grills are blocked.
3. Plug the power cord into a **120V AC / 60HZ** outlet.
4. Always lift your air purifier by the handle of the unit.



**Figure 1**

## **OPERATING INSTRUCTIONS**

The air purifier may be operated by the manual controls located on the air purifier (as shown in **Figure 1**).

1. Press **Power Button** to turn unit on.
2. Press **Fan Speed Button** to select fan speed MODE 1 – 3.  
**(1 = lowest speed setting; 3 = highest speed setting)**
3. Turn on the UV-C lamp and Ionizer ON or OFF by using **UV&ION** Button.  
Press **the** Button to cycle through the following modes:  
Mode 1 – Both UV lamp and Ionizer are on.  
Mode 2 – Ionizer off, UV lamp on.  
Mode 3 – Ionizer on, UV lamp off.  
Mode 4 – Both UV lamp and Ionizer are off.

## **TIMER FUNCTION:**

This function will work in any mode. The timer function allows you to set the length of operation from 1 hour (**1H**) to 8 hours (**8H**). Press **Timer Button** to set your

desired operation time. Once the timer is set, the timer indicator will lit and the timer will count down the hours till the air purifier turn itself off. Pressing **Timer Button** once more after the timer indicator reflects 8 hours (**8H**) will reset the air purifier to continuous running.

**\*Filter Replacement Indicator:** The HEPA reset light on the control panel will illuminate indicating that it is time to replace your filter. Replace the filter according to directions, then insert the tip of a pen into HEPA Reset area on control panel to reset HEPA filter. Depending on usage, filter will last for approximately 6 months.

## CLEANING AND MAINTENANCE

### REMOVING/INSTALLING HEPA FILTER (See Figure 2)

1. Turn off and unplug the unit.
2. Press the lock & release button and remove the rear cover from the unit.



**Figure 2**

3. Remove the used HEPA filter and dispose of it. Locate the arrow indicator on the filter and insert the filter in the correct orientation. (**See Figure 3**)



**Figure 3**

4. Install the rear cover back to unit and ensure it is flush with the surrounding surface and securely latch in place. **(See Figure4)**

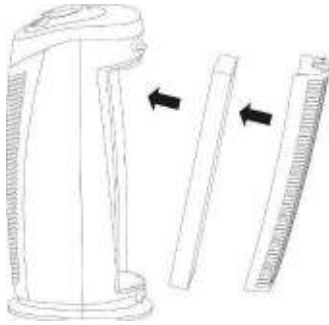

**Figure 4**

**NOTE:** Do not use water or any other household cleaners to clean the HEPA filter. Due to varying environmental conditions, the filter may need to be replaced earlier or later than indicated by the **HEPA Filter Reset Indicator**. If the HEPA filter turns from white to dark grey or black, it means you need to change the filter. If the HEPA filter is still white, it does NOT need to be replaced, even if the **HEPA Filter Reset Indicator** on the LCD is blinking. Please contact the manufacturer to purchase a new HEPA filter.

### **CLEANING PRE-FILTER (See Figure 5)**

1. Turn off and unplug the unit.
2. Press the lock & release button and remove the rear cover from the unit.



**Figure 5**

3. Remove the pre-filter from the **HEPA Filter**. **(See Figure 6)** Clean the pre-filter with the vacuum brush attachment of your vacuum cleaner. This will remove lint

and dirt from the filter.

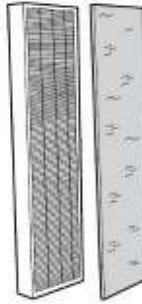

**Figure 6**

4. After cleaning, reattach the pre-filter to the **HEPA Filter** and install the rear cover back to onto the unit and securely latch in place. (**See Figure 7**)

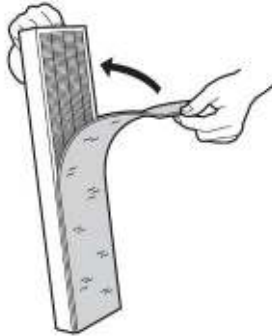

**Figure 7**

5. To ensure optimal performance, clean the pre-filter often.

### **REMOVING/INSTALLING UV LAMP (See Figure 8)**

1. To access the UV lamp, remove the rear cover and HEPA filter. After removing HEPA filter, use a screwdriver to remove the two screws holding the UV shield and remove the UV shield.



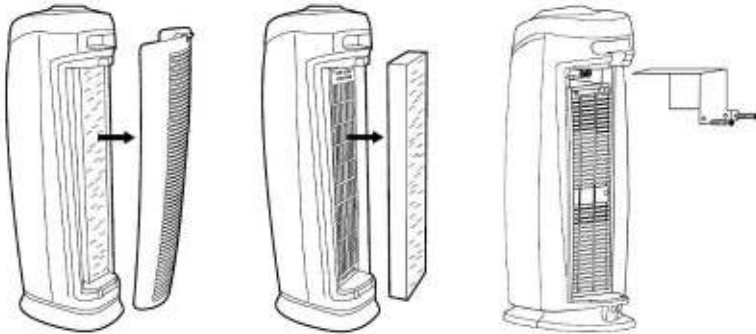

**Figure 8**

2. To remove the UV lamp, rotate it 1/4 turn and then slide it out of the lamp socket.  
**(See Figure 9)**

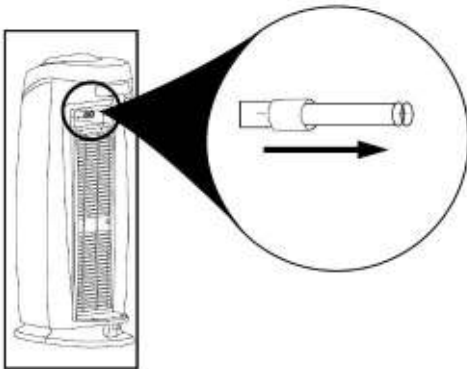

**Figure 9**

3. To install the UV lamp, slide it into the lamp socket and rotate it 1/4 turn.
4. The UV lamp should be replaced once a year.

## **MAINTENANCE**

1. The air purifier should be checked once a month.
2. Clean the pre-filter with the vacuum cleaner, which will remove lint and dirt.
3. Use a clean, dry, soft cloth to wipe the external surface of unit.

**NOTE:** Do not stick any foreign objects or your fingers into the unit.

**CAUTION:** Do not use gasoline, benzene, thinner, harsh cleaners, etc., as they will damage the product. NEVER use ALCOHOL OR SOLVENTS.

## TROUBLE SHOOTING TIPS

If the air purifier shuts off unexpectedly, safety features may have been activated to prevent damage or injury. If this happens:

1. Make sure the air purifier is plugged into a working electrical outlet.
2. Make sure the HEPA filter is firmly seated in place.
3. Make sure the rear cover is latched firmly in place.

**NOTE:** IF YOU CONTINUE TO EXPERIENCE A PROBLEM, PLEASE RETURN THE AIR PURIFIER TO THE PLACE OF ORIGINAL PURCHASE. **DO NOT ATTEMPT TO TAKE APART THE UNIT BY YOURSELF.** DOING SO WILL VOID YOUR WARRANTY AND MAY CAUSE DAMAGE TO THE PRODUCT OR PERSONAL INJURY.

## **3 YEAR LIMITED WARRANTY**

To the consumer, InvisiClean warrants this product to be free of defects in materials or workmanship commencing upon the date of the original purchase. Save your original sales receipt to validate start of warranty period. Warranty is not valid without receipt.

If this product should become defective within the warranty period, we will repair or replace any defective parts free of charge. All warranty repairs must be completed by InvisiClean. This warranty does not cover unauthorized repairs. The warranty does not include unusual wear, damage resulting from accident, or unreasonable use of the product. This warranty only covers the product when used with genuine InvisiClean accessories. This warranty covers product that was purchased from authorized distributors. This warranty gives you specific legal rights and you may also have other rights (other rights may vary from state to state in the U.S.A.).

To submit product under warranty the complete machine must be delivered pre-paid to InvisiClean. Please include complete information including: the problem, the model number of the product, the day of purchase, and a copy of the original sales receipt along with your name, address, and telephone (email optional). Please contact the original authorized retailer for return authorization and instructions.